

# ERGOCUT S 45

P L A S M A   R A N G E

## TECHNICAL DATA

Voltage class	M
Standard length m	4 • 6
Air consumption	115 l/min
Air pressure	5 bar
Duty cycle 60%	40 A
Air pressure switch	3.5 bar

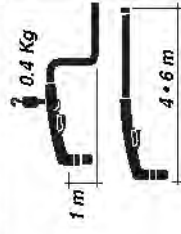

**S 45** m

<b>FITTING</b>	<b>PA0165</b>	6
<b>7/4 G</b>		
<b>FITTING</b>	<b>PA0167</b>	4
<b>Separate voltage</b>		
<b>Central adapters</b>	<b>PA0168</b>	6

### DECLARATION OF CONFORMITY

The undersigned company Trafimet - Via del Lavoro, 8 - 36020 Castegnero (VI) - Italy - declares that the product identified and described on this page complies with standard EN 60974-7 in accordance with the requirements contemplated by directive **EEC 73/23 low voltage**.



EN 60974-7

**trafimet**<sup>®</sup>  
your welding partner

# ERGOCUT S 45

PLASMA RANGE

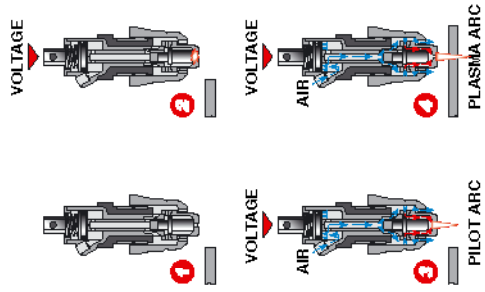

- 1 Torch off.
- 2 By pressing the trigger the torch will be fed by the current thus causing a temporary short circuit between electrode and tip.
- 3 The air then pushes up the small piston, thus creating, between the electrode and the tip, the distance needed to strike the pilot arc.
- 4 By positioning the torch on the part to be cut, the plasma arc will strike.

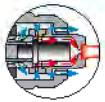

COOLING AIR  
CUT AIR

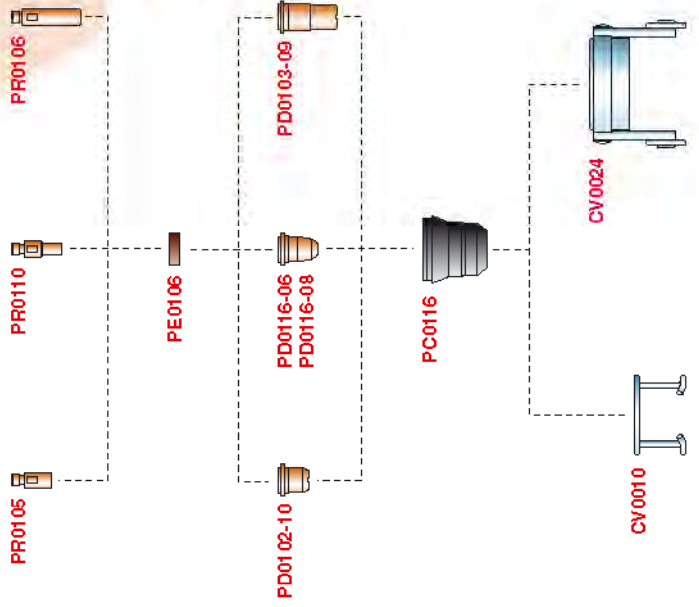
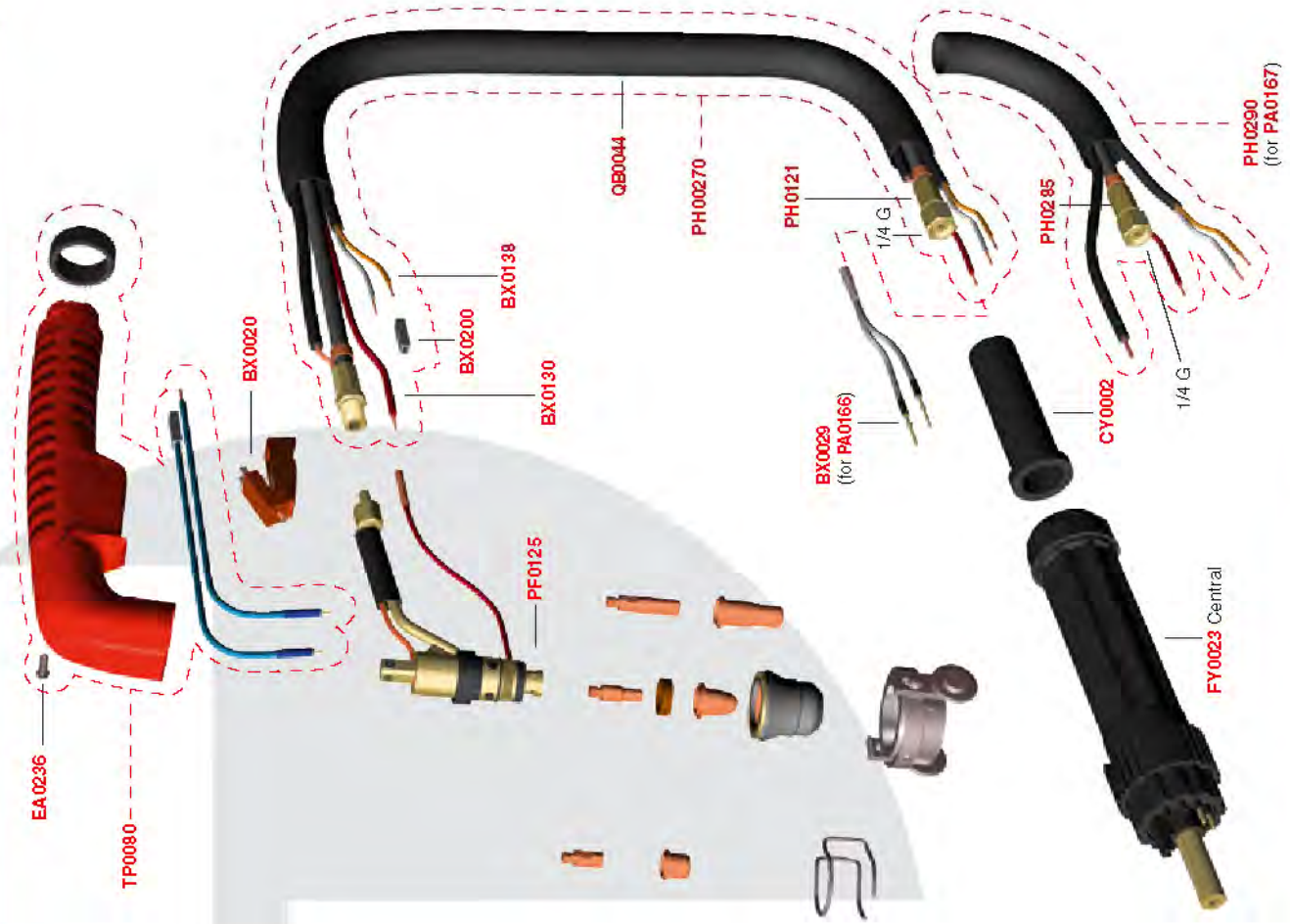
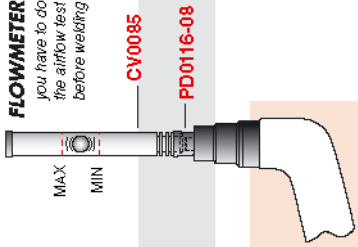

**trafimet**  
your welding partner



# PLASMATOORTS ERGOCUT S 45

artikelnummer

Omschrijving

Type

Leverancier	Tramex		
PA0165	<b>2512630090</b>	Plasma snijtoorts 4 mtr.	Ergocut S 45 1/4G
PA0167	<b>2512630089</b>	Plasma snijtoorts 4 mtr.	Ergocut S 45 ext.str
PA0166	<b>2512630088</b>	Plasma snijtoorts 4 mtr.	Ergocut S 45 C.A.
PA0148	<b>2512630092</b>	Plasma snijtoorts 6 mtr.	S 45 Selco
PR0105	<b>2522632105</b>	Snij-electrode	S45+S54
PE0106	<b>2522632104</b>	Luchtverdeler	S45+S54
PD0102-10	<b>2522632106</b>	Snijmondstuk 1.0 mm	S45+S54
PR0110	<b>2522632054</b>	Snij-elektrode	S 45
PE0106	<b>2522632104</b>	Luchtverdeler	S45+S54
PD0116-06	<b>2522632080</b>	Snijmondstuk	S 45
PD0116-08	<b>2522632057</b>	Snijmondstuk	S 45
PR0106	<b>2522632107</b>	Snij-electrode lang	S45+S54
PE0106	<b>2522632104</b>	Luchtverdeler	S45+S54
PD0103-09	<b>2522632108</b>	Snijmondstuk lang 1,0 MM	S45+S54
PC0116	<b>2522632059</b>	Gasmondstuk	S 45
CV0010	<b>2552650195</b>	Afstandveer	S45+CB70 1394
CV0024	<b>2522632061</b>	Snijwagen	S 45
TP0080	<b>2522632063</b>	Handgreep kpl.	S 45
EA0236	<b>2522632064</b>	Inzetschroeven handgreep	Diverse plasma
BX0020	<b>2162609021</b>	Drukschakelaar	Diverse toortsen
PF0125	<b>2522632051</b>	Branderlichaam	S 45
BX0130	<b>2522632078</b>	Kabelpilotboog	S 45
BX0138	<b>2522632079</b>	Controle kabel	S 45
BX0200	<b>2202611330</b>	Stekker	MEGA 2+3+4+5
QB0044	<b>2522632084</b>	Beschermhoes rubber	S 45 14x16,5
PH0270	<b>2522632082</b>	Toortspakket 4M 1/4"	S 45
PH0121	<b>2522632081</b>	Luchtkabel 6M 1/4"	S 45
BX0029	<b>2522632085</b>	Dubbele plug	S 45
PH0285	<b>2522632067</b>	Str.luchtkabel 6 mtr. 1/4	S 45
PH0290	<b>2522632083</b>	Toortspakket 4M 1/4"	S 45 sep. gas
CY0002	<b>2162609726</b>	Buigbescherming	Diverse toortsen
FY0023	<b>2522632130</b>	C.A. 5-pins Kpl. T.Z.	Diverse plasma
CV0085	<b>2522632135</b>	Flowmeter	S 54
CV0025	* <b>2522632062</b>	Snijwagen-passer-set	S 45